

ASHLAND STATION

Construction Notice

April 2019

What to Expect

As part of the Elevator Installation Project, PATCO is installing a new elevator at Ashland Station that will be completed in the spring of 2020.

Beginning on Monday, April 22, 2019, the following changes will occur at the station to make room for the new elevator:

- The stairs leading to the West Headhouse will be demolished and rebuilt. The new staircase will open in December 2019.
- The gates will be moved back several feet to make room for the new staircase.

Please be advised that, while the station will remain open and trains will continue to run as usual, these construction impacts may affect the time you need to board your train, especially during rush hour. In the interest of minimizing this disruption, the direction of the escalator will be reversed at times of peak demand to get you to and from the platform more easily.

PATCO apologizes for any inconvenience this temporary measure may have on your commute. Your patience is greatly appreciated.

During Construction

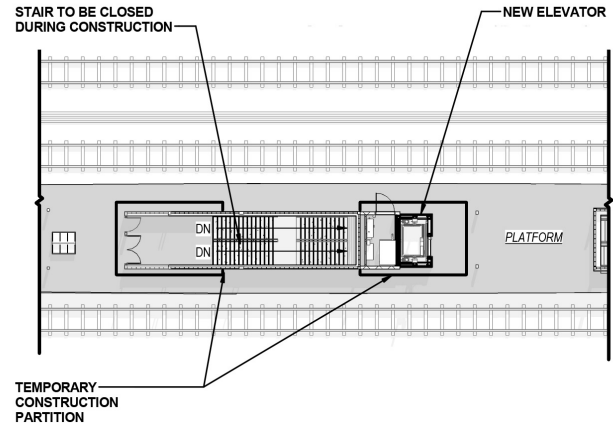

During Construction

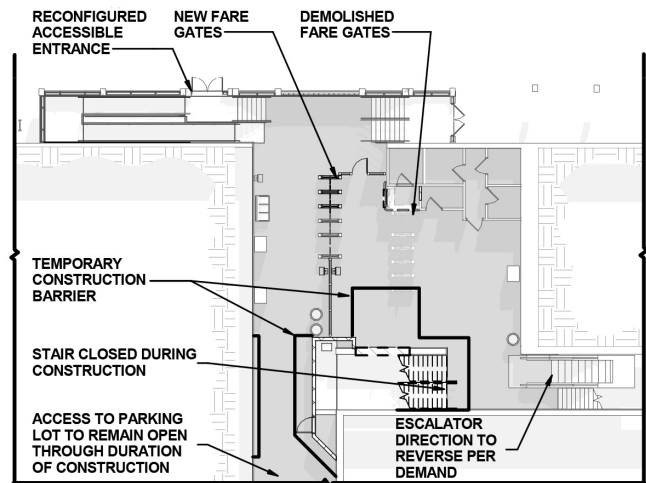

After Construction

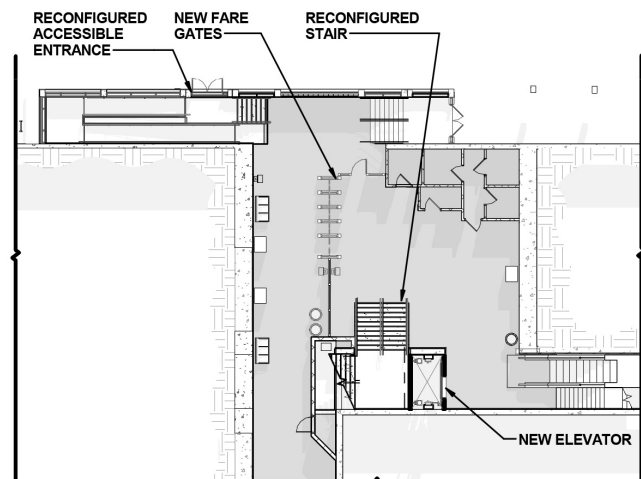

PATCO strives to improve our service and facilities.

Read more about our current project at www.ridepatco.org/projects

**Toll-Free Project Information Line
1-866-433-7762**